

Porter Tun

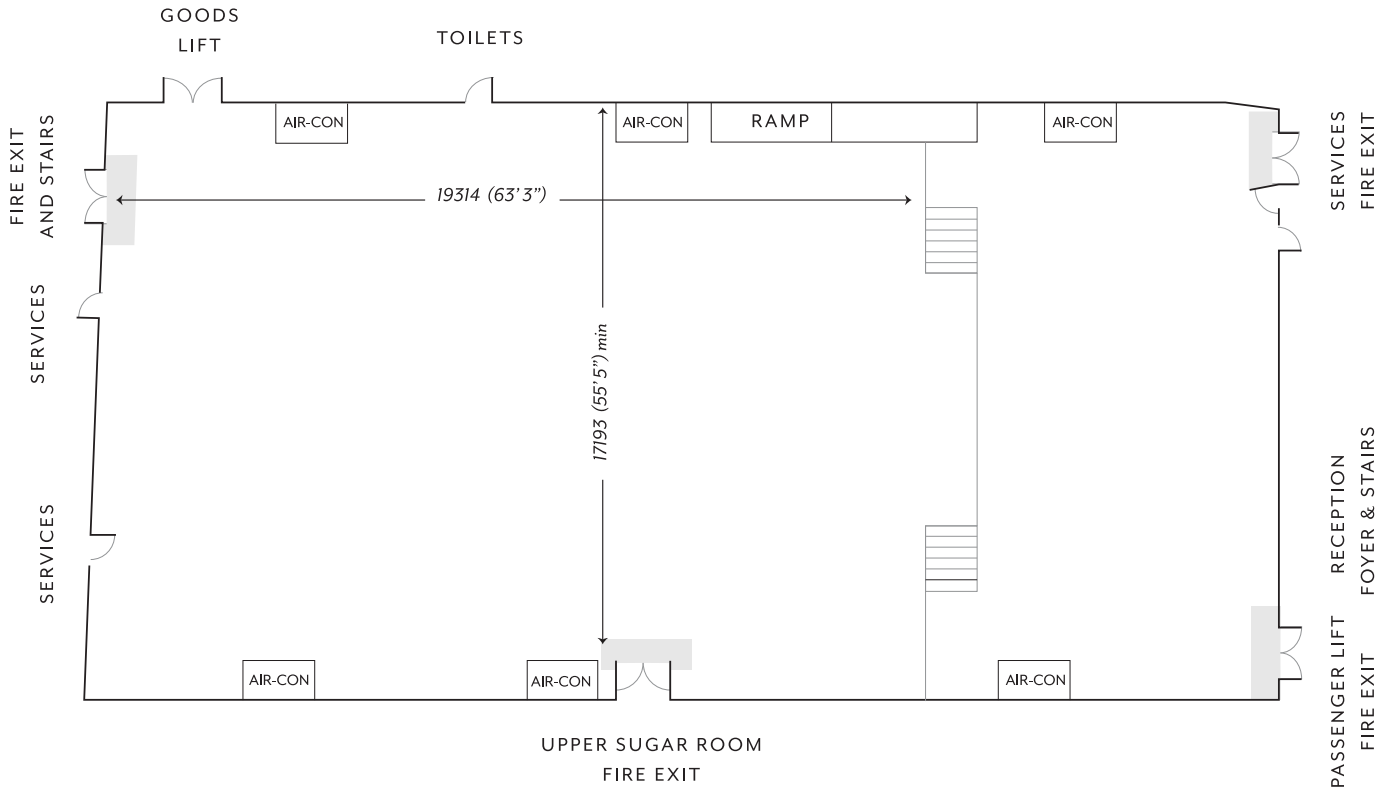

FEATURES

The Porter Tun is perfect for large gatherings for up to 1000 guests and is one of the most striking rooms available in London.

An exposed King Post timber roof gives a clear span of 60ft above a 778 square metre antique wooden floor making it a perfect location for larger wedding parties looking to host the whole wedding in one room. The large raised balcony is ideal for a reception area allowing for a grand reveal to your wedding breakfast on the main floor.

Fully equipped with state-of-the-art sound system, Wi-Fi and fully integrated LED lighting system. Fully air controlled with natural daylight.

CAPACITY

Ceremony	800
Dinner	700
Dinner/Dance	600
Reception	1000
Reception (Balcony only)	400

FLOOR AREA

Floor area (m ²)	778
Length (m)	40.34
Width (m)	19.2
Max Height (m)	4.3
Min Height (m)	3.3